



Randy E. Hayman, Water Commissioner

9 November 2022

Dear Philadelphia Water Customer,

I am writing to let you know that the Philadelphia Water Department (PWD) is **planning a construction project** in your neighborhood. This stormwater management project will take place in the public right of way (streets, sidewalks, and parks) near your property.

This project is a part of the **City of Philadelphia's Green City, Clean Waters initiative** – a 25-year plan to improve the quality of our waterways by installing green stormwater infrastructure (GSI) in our neighborhoods, coupled with traditional infrastructure like collection, pumping, and wastewater treatment plant enhancements. These 'green tools' installed in your area will absorb stormwater that would normally overflow into our local creeks, streams, and rivers during heavy storms. For more information on our stormwater management plan, please visit: water.phila.gov/green-city/

As part of this construction work, which is called **GSI Project #50279 Holman Field**, PWD is planning to install the green tools listed below at the following locations:

- **A stormwater tree trench system** along Cherokee Street

To find out more details about this GSI project, please visit: water.phila.gov/projects/p50279/

More information about the specific green tools planned for your area can be found at the in the enclosed document(s), on our project page website (above), and on our big green map of GSI, found here: phillyh2o.info/green-map

The contractor assigned to this job is **Seravalli, Inc.** and **construction is expected to begin in approximately 2-6 months.** However, please note that *this is an estimate*, and the construction start date can be earlier or later than the anticipated timeline.

A follow-up letter will be sent closer to the time of construction. In the meantime, please reach out to both myself and Amy Hopf, our Construction Outreach Specialist (Amy.Hopf@phila.gov), with any questions.

If you want to receive email notifications from PWD, please visit phillyh2o.info/signup to register.

Sincerely,

Jackie Ng & Maura Jarvis

Philadelphia Water Department

Community Outreach Specialist to Northeast and Northwest Philadelphia

1101 Market Street, 6th Floor

Philadelphia PA 19107

Jackie.Ng@phila.gov | Maura.Jarvis@phila.gov

Holman Field

Planned Green Infrastructure

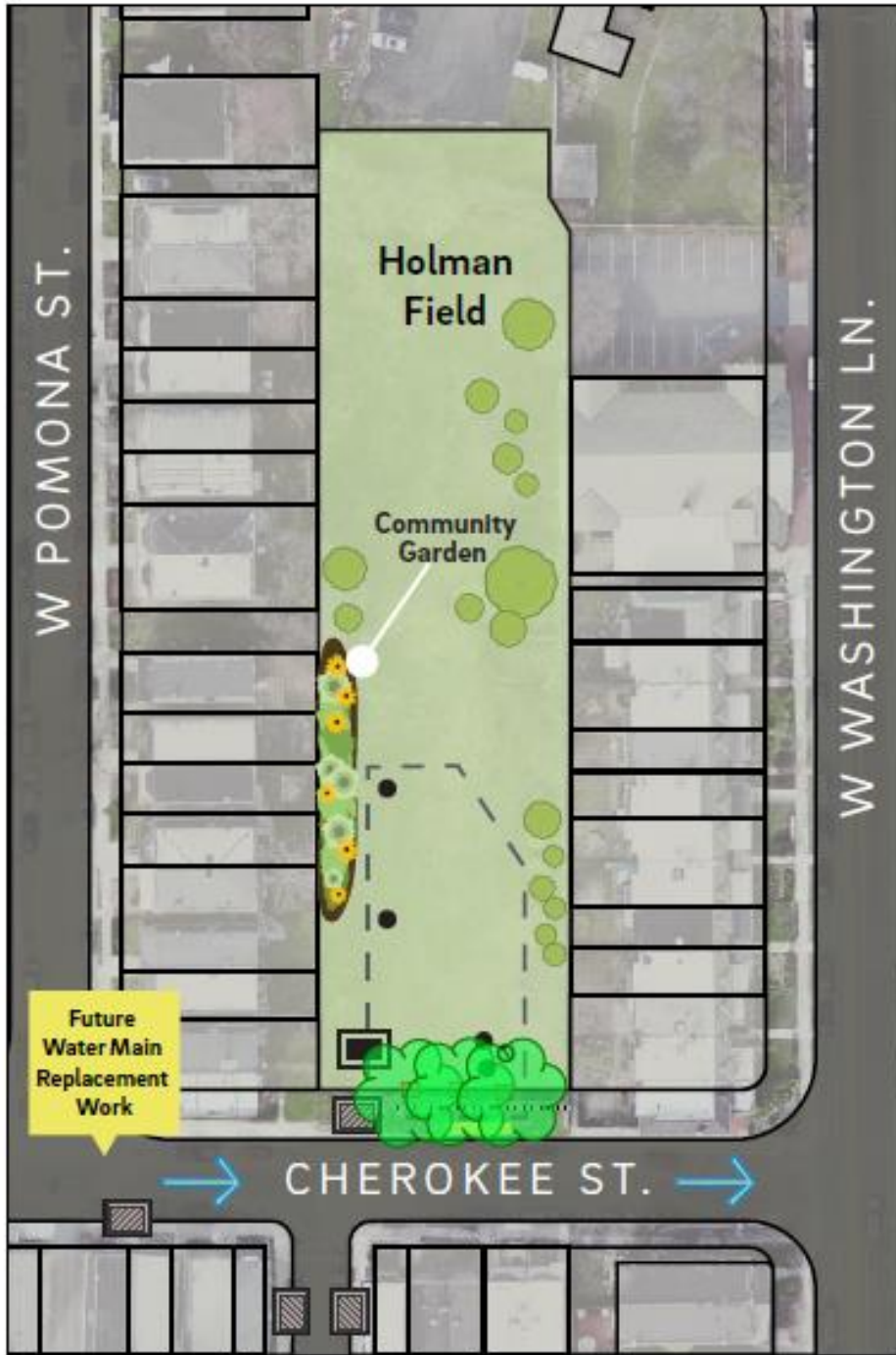

Key

-  Subsurface Storage Basins
-  Landscaped Areas
-  Existing Tree
-  Direction of Stormwater Flow
-  Green Inlet
-  Junction Box
-  Cleanout
-  Observation Well
-  Chain Link Fence
-  Holman Field Sign

Elements on map are shown for location only, not to scale.