

FIELD CUT PLAIN
END PIPE

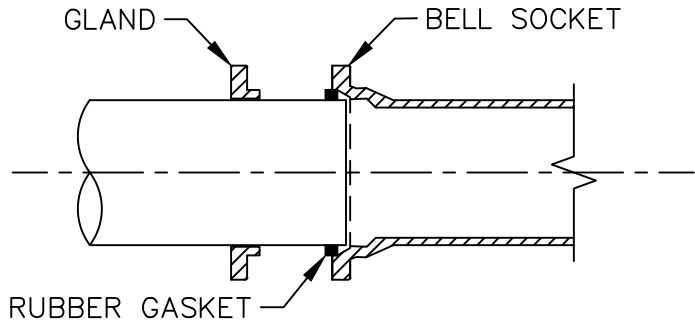

INITIAL ASSEMBLY

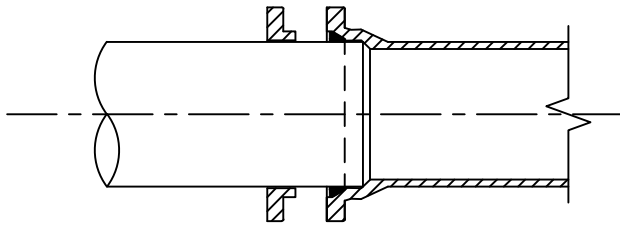

PARTIAL ASSEMBLY

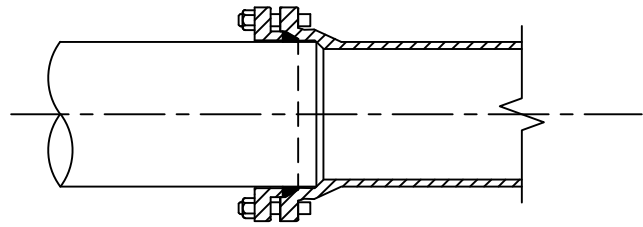

FULL ASSEMBLY

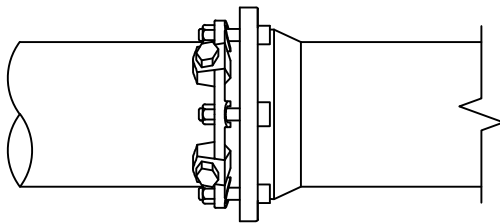

COMPLETED ASSEMBLY
WITH WEDGE ACTION
RETAINER GLAND

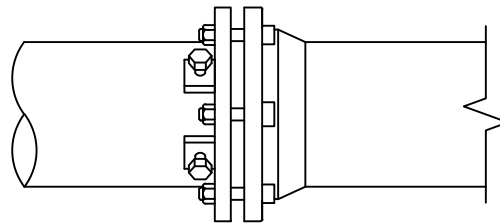

COMPLETED ASSEMBLY
WITH SET SCREW
RETAINER GLAND

JOINT SHALL BE ASSEMBLED WITH NO DEFLECTION. JOINT DEFLECTION, IF NECESSARY AND WITHIN ALLOWABLE LIMITS, SHALL BE MADE AFTER FULL ASSEMBLY WITH HAND TIGHTENED T-BOLTS. AFTER JOINT DEFLECTION, TIGHTEN T-BOLTS AND RESTRAINING DEVICES TO MANUFACTURERS RECOMMENDED TORQUE

PHILADELPHIA WATER — DEPARTMENT —	MECHANICAL JOINT WITH RETAINER GLAND ASSEMBLY		
	DRAWN BY: D&B GUARINO	DATE: FEB. 2022	
CHECKED BY: WD	DETAIL ID: INSTALL-02	REV.: 1	