



Randy E. Hayman, Water Commissioner

2/3/2023

Dear Philadelphia Water Customer:

You are receiving this letter as a notification that a Water Department construction job is soon to begin in your neighborhood. Our work will take place soon on the blocks listed below, and as a neighbor in this community we want you to be aware of possible traffic disruptions and delays while this work is ongoing.

This project is part of the overall green infrastructure plan called *Green City, Clean Waters*, implemented by the City of Philadelphia to improve the stormwater management of your neighborhood. Green stormwater infrastructure includes a range of soil-water-plant systems that intercept storm water, infiltrate a portion of it into the ground, evaporate a portion of it into the air, and in some cases release a portion of it slowly back into the sewer system.

Prior to work starting on each of these blocks, residents directly impacted by this work will receive an additional hand delivered letter to their home alerting them that work is soon to begin. This project will take place at these locations:

Street	From	To	Type of Work
Holman Field (<i>Cherokee St. between W. Pomona St. and Washington Ln.</i>)			Stormwater Management
Cherokee St.	W. Duval St.	Washington Ln.	Stormwater Management
Cherokee St.	W. Duval St.	Washington Ln.	Water Main Replacement

Project Info: #50279 Holman Field

Contractor: Seravalli Construction

Estimated Project Dates: March 2023 – August 2023

- During normal working hours (7:00am-3:30pm) it may be necessary to close the street
- Trash should be placed at the curb as regularly scheduled
- The Water Department has assigned an engineer and inspector to the project who will be on-site every day
- Our engineer and inspector will ensure that the work proceeds in a safe and workmanlike manner
- Should you experience any problems as a result of the work, please talk with the inspector on the job site who will be wearing clothing identifying him/her as a Water employee
- The inspector will notify you one day in advance of any scheduled water shut-offs, of which several may be required over the course of the project

If you are unable to contact the inspector at the job site, or have any other questions, please contact the engineer at the number listed below between 8:00 a.m. - 4:30 p.m. Monday thru Friday. Should a water emergency occur, please call the Water Department hotline at (215) 685-6300. Questions can be sent to waterinfo@phila.gov. **Further information about this project can be found at water.phila.gov/50279.**

Sincerely,
Frank Stollenwerk
Division Engineer
215-964-8036

If you need a copy of this information in another language, please call the number above.

Flip over for project #50279 map and community garden mock-up >>>

Holman Field

Planned Green Infrastructure

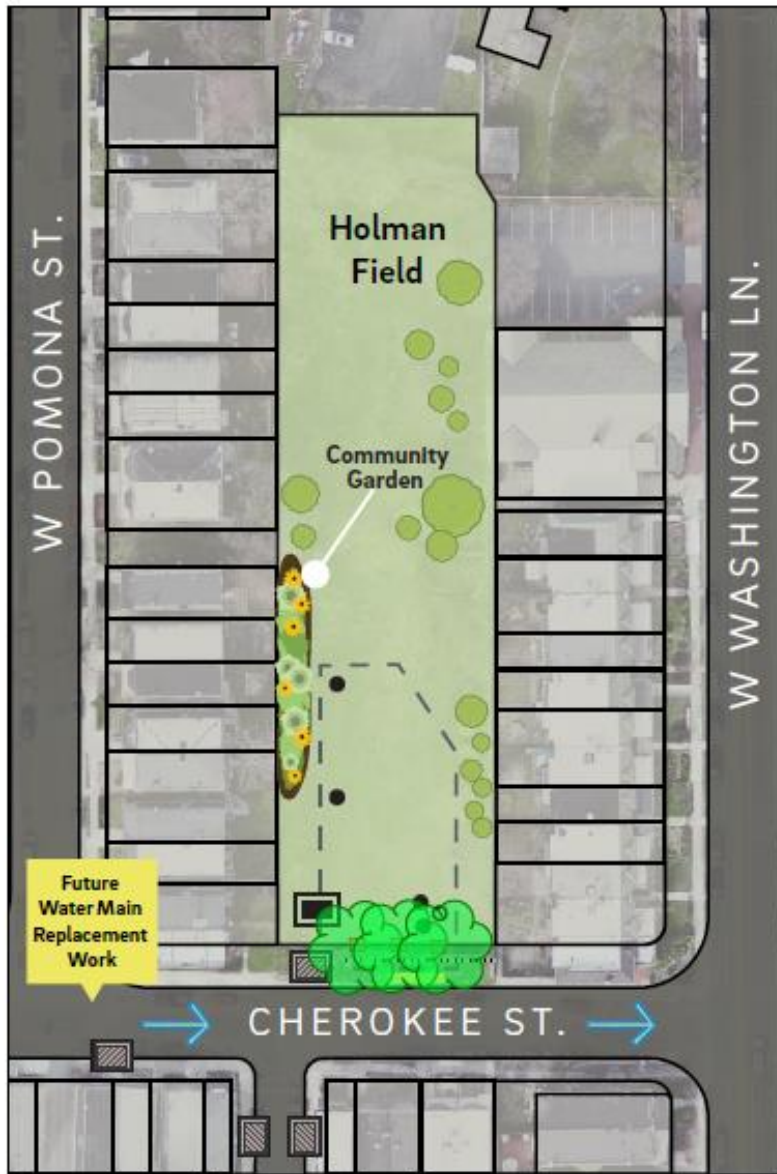

Key

- Subsurface Storage Basins
- Landscaped Areas
- Existing Tree
- Direction of Stormwater Flow
- Green Inlet
- Junction Box
- Cleanout

Elements on map are shown for location only, not to scale.

