

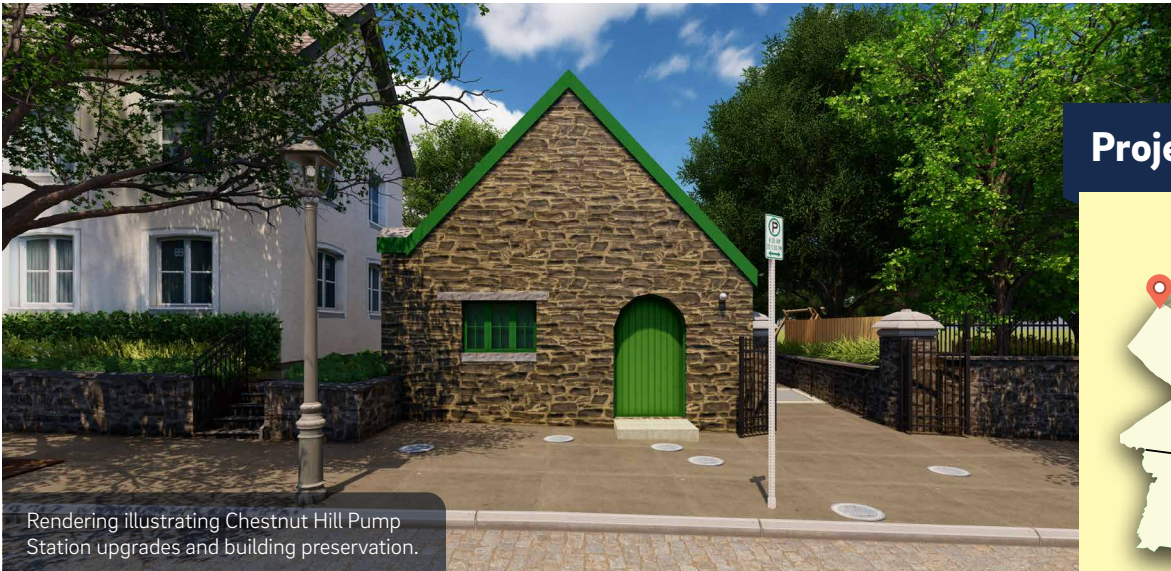

Chestnut Hill Pump Station Upgrades

This historic pump station was built in 1924 to serve the Chestnut Hill neighborhood. In collaboration with the J.S. Jenks School and Chestnut Hill Conservancy, this project will modernize the pump station and preserve the historic character of the building.



Rendering illustrating Chestnut Hill Pump Station upgrades and building preservation.

Project Information



Project location in Philadelphia

Why do we need to replace this pump station?

The Chestnut Hill Pump Station has served Philadelphia for over 100 years. The last major upgrades to the site in 1957 extended its useful life, but it now needs to be modernized. Upgrading the aging and inefficient equipment will reduce maintenance costs and improve service to Chestnut Hill.

How will this construction impact me?

Construction is not expected to disrupt water service. However, if PWD needs to temporarily shut off water services in the area, a representative will notify you in advance.

This project includes a new water main connection that will require temporary closures on Germantown Ave. Visit the project page for anticipated detour information.

What are the benefits of this project?

- **Improved service.** The upgraded pump station will increase the reliability of water pressure in Chestnut Hill.
- **Clean drinking water.** Upgrading the pump station is critical for continued delivery of safe and clean drinking water to Chestnut Hill.
- **Reduced maintenance cost.** New equipment is less costly to maintain.
- **Historic preservation.** Restoring the pump station's exterior to preserve its historic character.

Neighborhoods Served

Chestnut Hill

What does a pump station do?

A pump station houses pumps, pipes, valves, and electrical equipment to move water through our system. This equipment helps provide reliable drinking water service and pressure to homes and businesses.



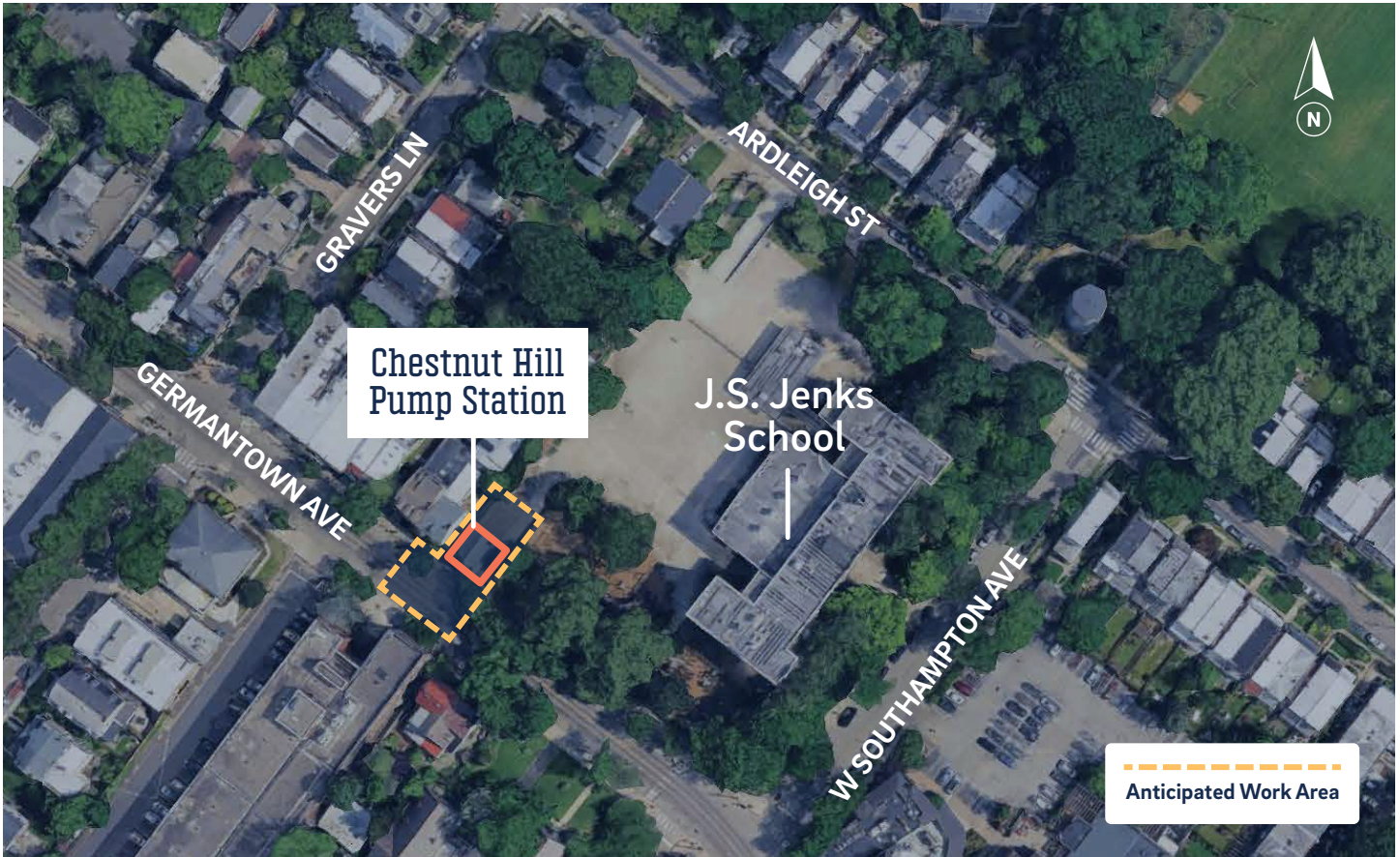

PWD is upgrading the Chestnut Hill Pump Station located along Germantown Ave. For more information on this two-part project, visit the project page at the QR code below.

Anticipated Timeline*



i Construction is carefully phased to reduce disruptions during the school year.



This is a *Water Revitalization Plan* project:

This project is one of dozens in Philadelphia’s multidecade plan to strengthen and upgrade essential drinking water infrastructure. From upgraded facilities to new water mains for improving our water system, these projects will benefit all neighborhoods across Philadelphia.

**Dates are subject to change.*



Scan or visit water.phila.gov/projects/p64099 for the latest updates on this project.

