

ERIE AVENUE GREEN INLET

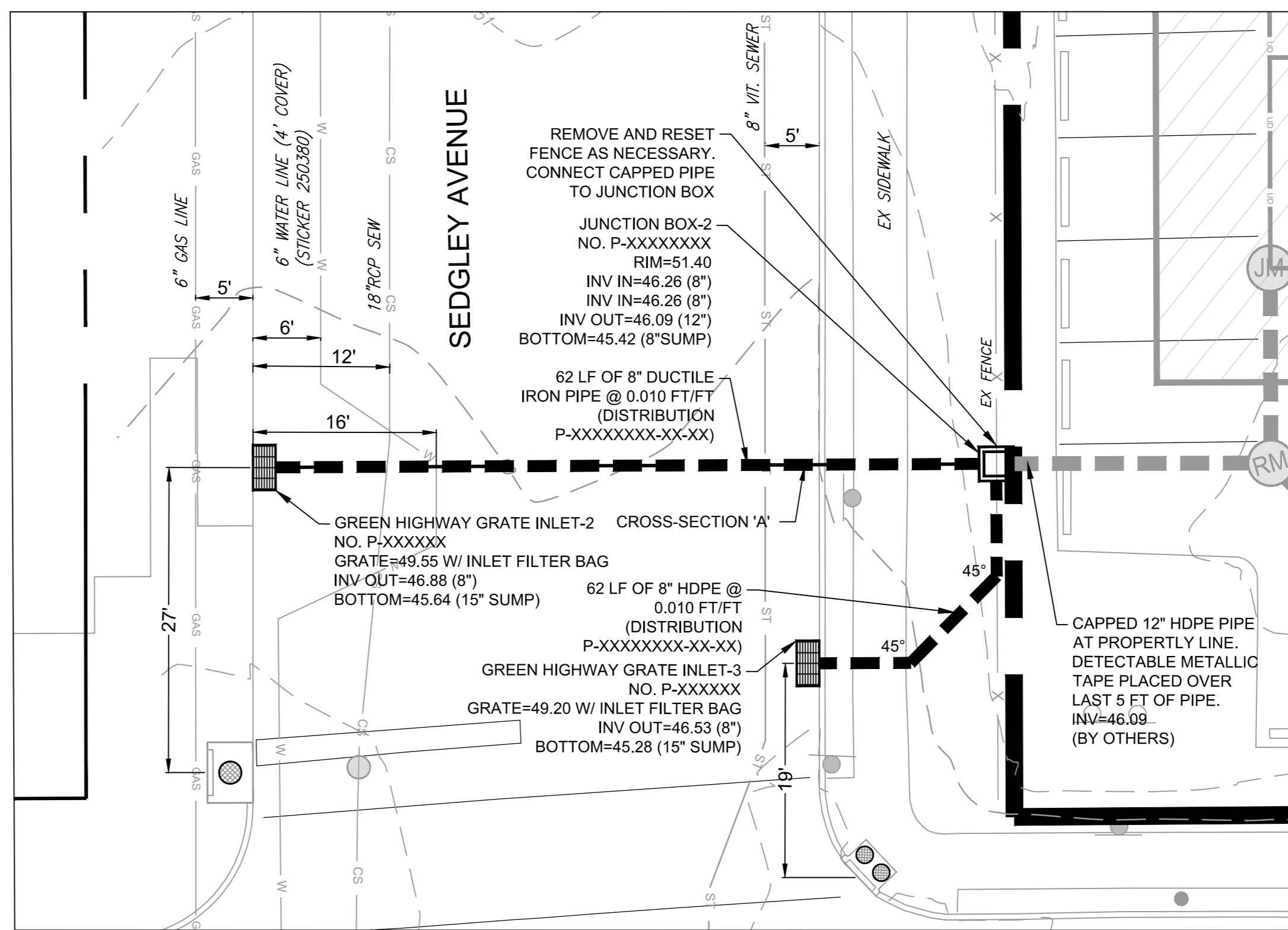

SEDGELY AVENUE GREEN INLETS

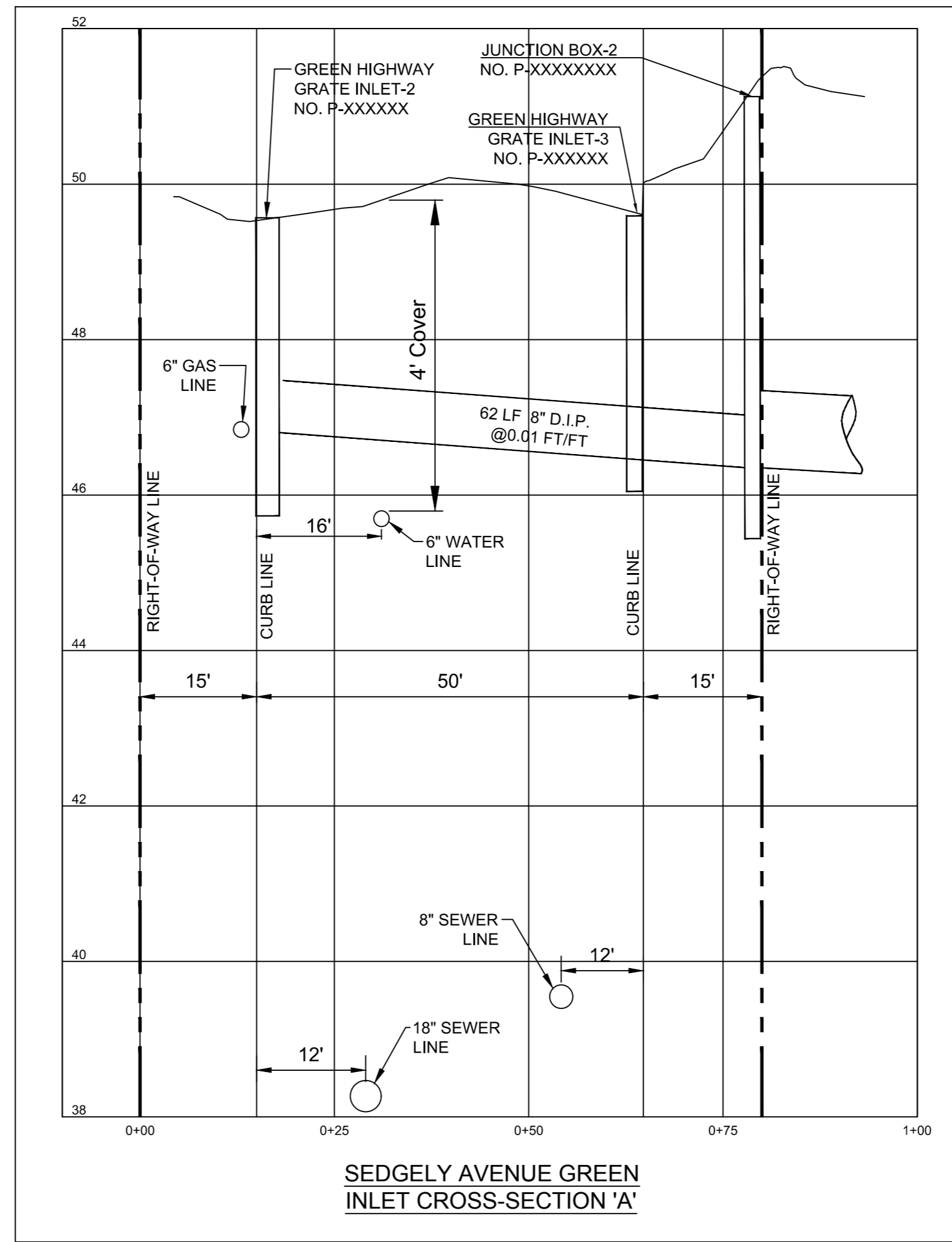
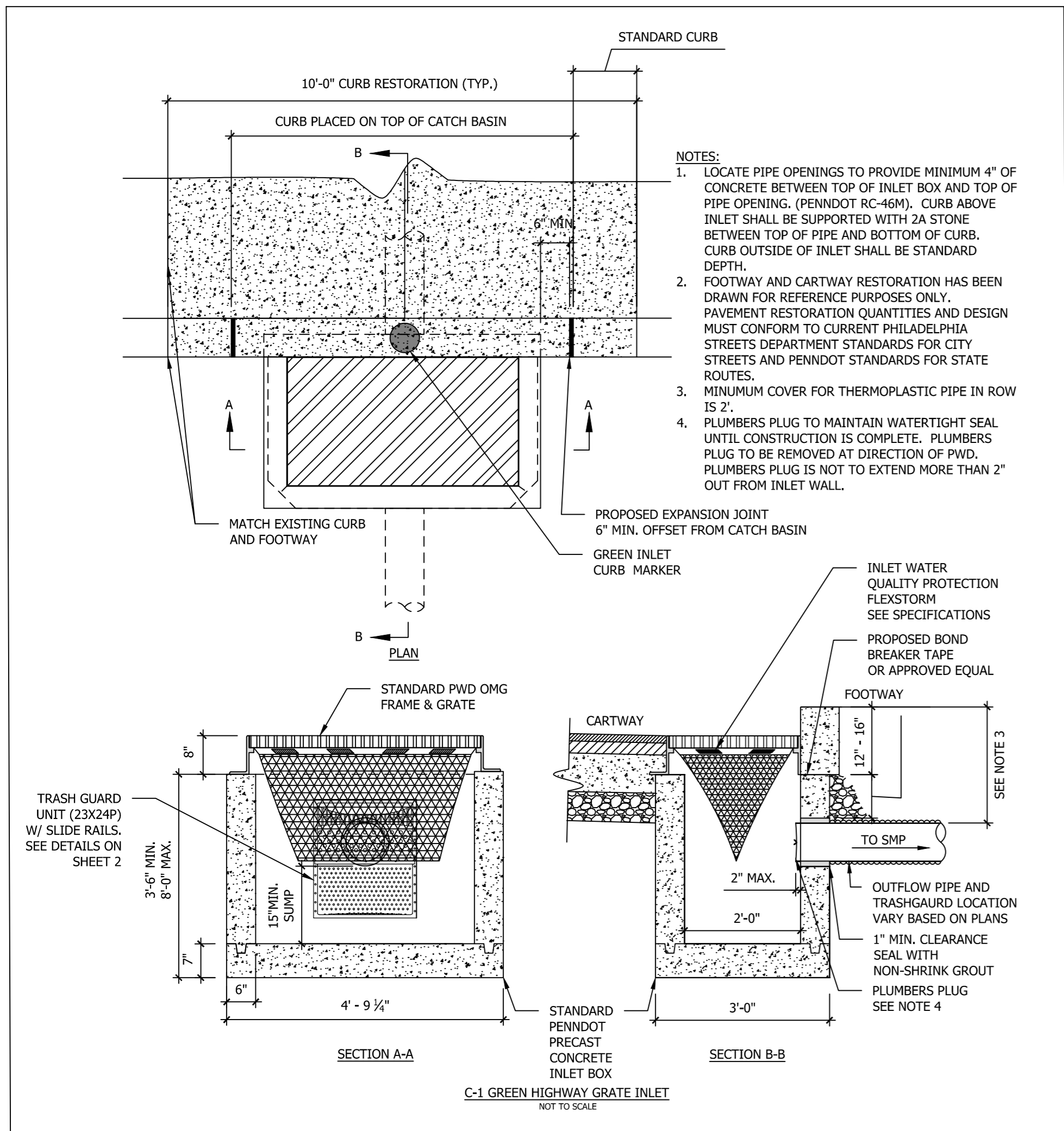
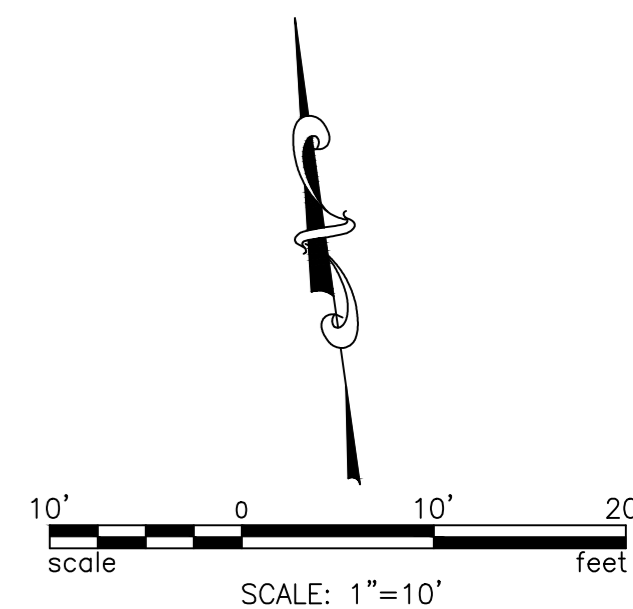

LEGEND:

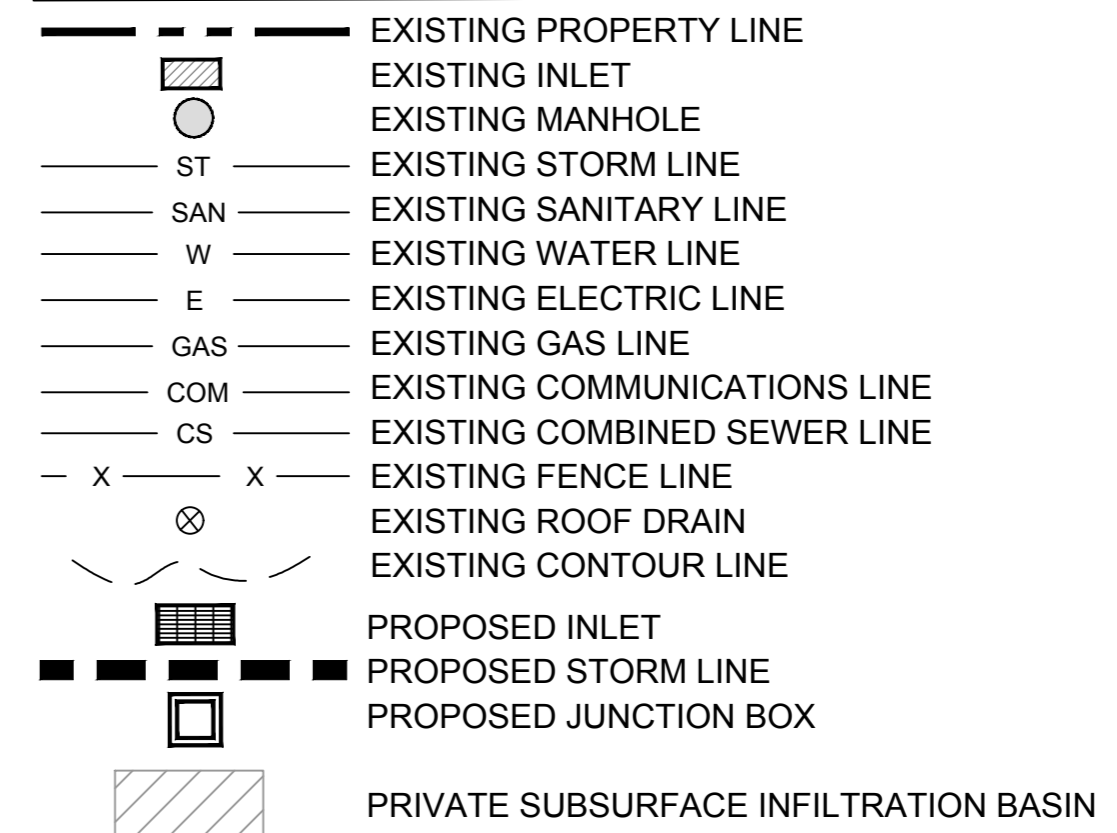

STANDARD NOTES:

- THE APPROVED WORK TIES INTO A PRIVATE STORMWATER MANAGEMENT SYSTEM LOCATED AT 1100 E ERIE AVENUE. PLEASE REFER TO PROJECT TRACKING # FY18-EERI-4992-01 FOR DETAILS OF PRIVATE SYSTEM.
- THE CONTRACTOR MUST PROVIDE AS-BUILT RECORD DRAWINGS PER PWD GREEN STORMWATER INFRASTRUCTURE AS-BUILT SURVEY & DRAFTING MANUAL REQUIREMENTS.
- CONTACT THE STREETS DEPARTMENT AT LEAST TWO WEEKS PRIOR TO CONSTRUCTION FOR THE ROADWAY OPENING PERMIT, PAVING & TRENCH RESTORATION PROCEDURES, AND LANE CLOSURE PERMIT. CHECK THE DEPARTMENT'S WEBSITE FOR DETAILS AND CONTACT INFORMATION: [HTTP://WWW.PHILADELPHIASTREETS.COM/CUSTOMER-SERVICE/DOWNLOADS-AND-LINKS/](http://www.philadelphiestreets.com/customer-service/downloads-and-links/)
- CONTRACTOR MUST OBTAIN PERMISSION FROM THE STREETS DEPARTMENT TO STORE ANY MATERIALS ON THE STREET.
- THE APPROVED WORK SHALL BE DONE IN THE PRESENCE OF A PWD INSPECTOR.
- THE CONTRACTOR PERFORMING THIS WORK IS TO NOTIFY THE PWD CONSTRUCTION DIVISION, 1101 MARKET STREET, 2ND FLOOR, PHONE (215) 685-6345, AT LEAST 7 DAYS IN ADVANCE FOR ASSIGNMENT OF AN INSPECTOR OF THE JOB.
- THE CONTRACTOR IS RESPONSIBLE FOR OBTAINING ALL ADDITIONAL PERMITS AND APPROVALS FROM ALL AFFECTED CITY AGENCIES AND UTILITIES.
- ANY CHANGE TO, OR DEVIATION FROM, THE FINAL APPROVED DESIGN PLANS DURING CONSTRUCTION MUST BE APPROVED BY THE ASSIGNED PWD CONSTRUCTION ENGINEER AND BY THE PWD PROJECT ENGINEER.
- PLACE AND COMPACT BACKFILL IN ACCORDANCE WITH THE STANDARD SPECIFICATIONS FOR EXCAVATION, REFILLING, GRADING, AND REPAVING.
- ALL SIDEWALK AND CURBING TO BE REPLACED IN KIND ALONG FULL LIMITS OF CONSTRUCTION TO NEXT EXISTING JOINT OR AS DIRECTED BY PWD.
- MAINTAIN AND PROTECT EXISTING INLETS. SHOULD THE EXISTING INLETS BE IN ANY WAY DAMAGED DURING CONSTRUCTION, THESE SHOULD BE REPAIRED TO THE SATISFACTION OF THE PWD INSPECTOR OR REPLACED PER PWD STANDARDS.
- CONTRACTOR MUST COMPLY WITH EROSION AND SEDIMENT (E&S) CONTROL REQUIREMENTS DURING CONSTRUCTION. SEE PWD REGULATION 501.3 AND 600.4, PHILA. CODE S. 13-603, AND 25 PA CODE CHAPTER 102. THE CITY MAY REQUIRE THE CONTRACTOR TO CLEAN CITY-OWNED INLETS AND SYSTEMS AFFECTED BY NON-COMPLIANT OR FAILED E&S MEASURES.

GENERAL NOTES:

- PROPERTY LINE SHOWN IS TAKEN FROM DEED OF PROPERTY, AND 1-CALL UTILITY PLANS.
- SITE HORIZONTAL DATUM IS PENNSYLVANIA SOUTH STATE PLANE COORDINATES NAD 83, AND VERTICAL DATUM IS NAVD 88.
- EXISTING STRUCTURE INFORMATION BASED ON ACTUAL FIELD SURVEY PERFORMED BY H2O INFRASTRUCTURE, OR PLANS PROVIDED BY PWD.

8208APT 8308ZPT Assembly



Product Number
00820891W01

Design Features

- Materials
Cover: Gray Iron (CL35B)
Junction Box / Handhole Frame: Gray Iron (CL35B)

- Design Load: Heavy Duty
- Open Area: n/a
- Coating: Dipped
- Designates Machined Surface: ~

Certification

- ASTM A48
- Country of Origin: USA

Major Components

00820891
00830812

Drawing Revision

06/20/2011 Designer: JIJ
09/12/2014 Revised By: MAH

Disclaimer

Weights (lbs./kg) dimensions (inches/mm) and drawings provided for your guidance. We reserve the right to modify specifications without prior notice.

CONFIDENTIAL: This drawing is the property of EJ GROUP, Inc. and embodies confidential information, registered marks, patents, trade secret information, and/or know-how that is the property of EJ GROUP, Inc. All rights reserved.

Contact

800 626 4653
ejco.com

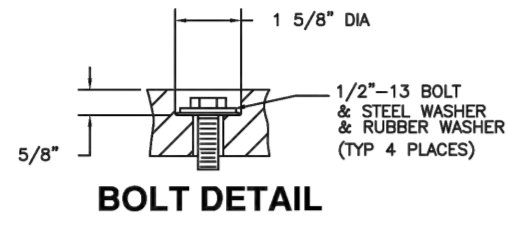
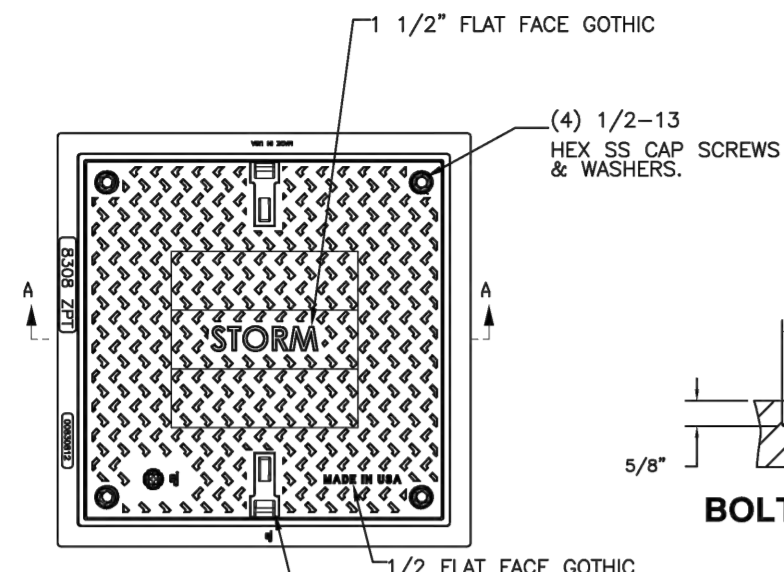

BOLT DETAIL

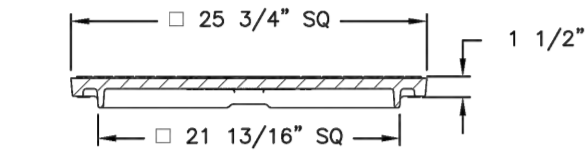

COVER SECTION

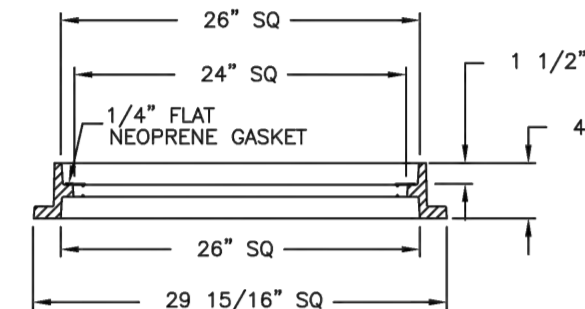

FRAME SECTION

NOTE: FRAME IS REVERSIBLE AND CAN BE INSTALLED AS A BOTTOM FLANGE UNIT.

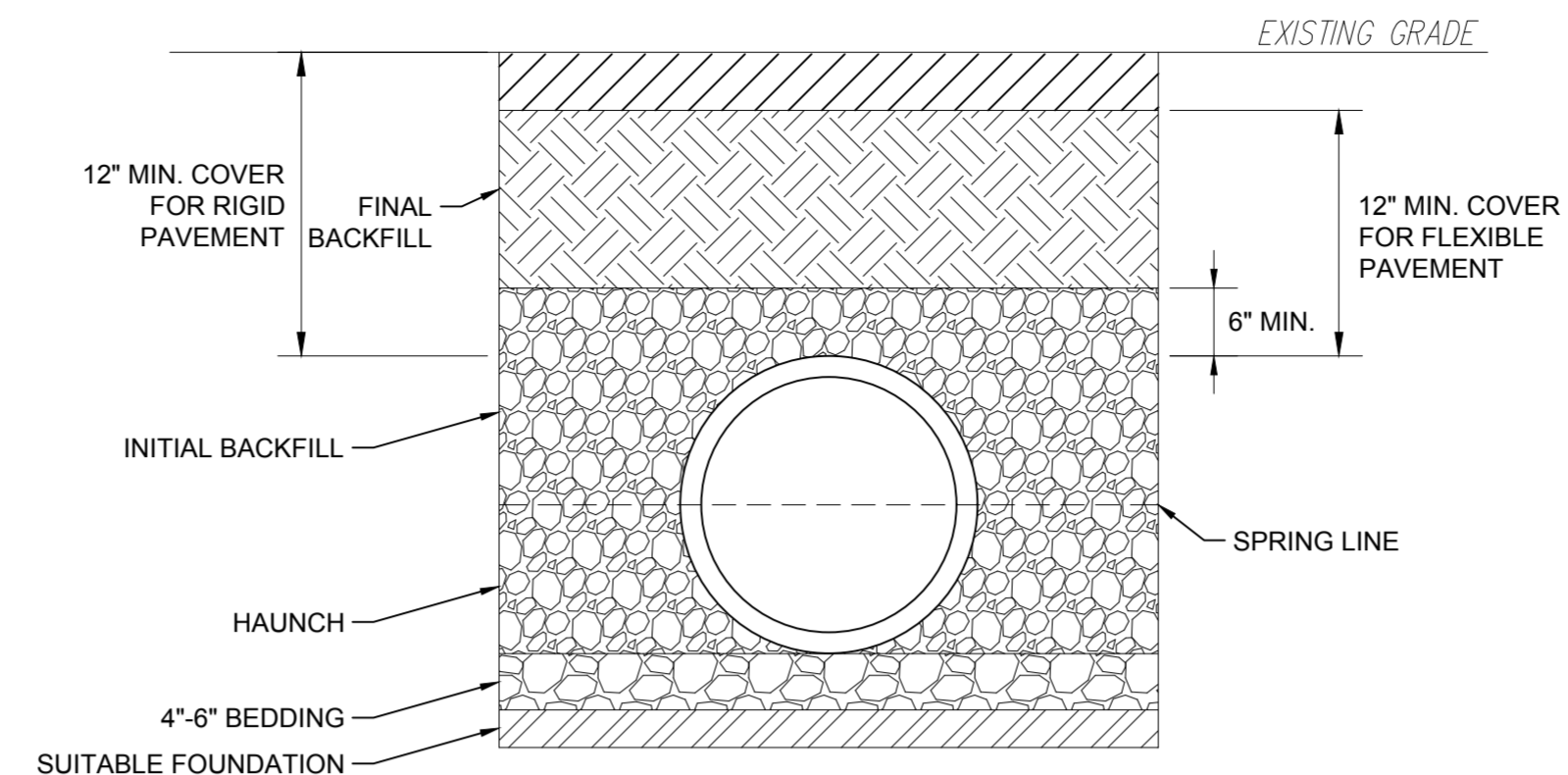

HDPE AND DUCTILE IRON PIPE BEDDING DETAIL
NOT TO SCALE

- BACKFILL WITH SUITABLE SOILS
- STRUCTURAL BACKFILL (COMPACTED CLASS I, II, OR III MATERIAL)

- TOTAL MINIMUM COVER INCLUDES 6" OF STRUCTURAL BACKFILL ABOVE THE PIPE CROWN AND THE FINAL FILL
- REFER TO ADS CORRUGATED PLASTIC PIPE STORM INSTALLATION GUIDE FOR ADDITIONAL INFORMATION
- POLYETHYLENE ENCASEMENT REQUIRED IF CORROSIVE SOILS ARE ENCOUNTERED. REFER TO ANSIAWWA C105/A21.5.

LIFT HANDLES
STAINLESS STEEL SUPPORT FRAME
STAINLESS STEEL BYPASS FLANGE
REPLACABLE FILTER BAG
STAINLESS STEEL CLAMPING BAND
ULTIMATE BYPASS AREA

FLEXSTORM INLET FILTERS - PRODUCT SELECTION FOR PENNDOT TYPE M,C INLETS		ADS				
FLEXSTORM PENNDOT TYPE M/C INLET FILTERS	Base Part Number	FX Bag (Woven)	FX+ Bag (FX Bag with Cleartec Skimmer Pouch)	PC Bag (Adsorb-it lined)	PC+ Bag (PC bag with Cleartec Skimmer Pouch)	FXO Bag (FX Bag with 3" dia oil boom)
Stainless Steel Framing	62PENNMHD	62PENNMHDFX	62PENNMHDFX+	62PENNMHDPC	62PENNMHDPC+	62PENNMHDFXO
RATINGS		**** Framing Bypass flow calculated using Orifice Flow Equation, Coefficient of discharge=0.67, C=CA(2gd) ^{0.5}				
Ultimate Bypass		Bypass flow rating using Orifice flow equation**** with 2 inches water depth over grate				
Standard 2" Bypass (62PENNMHD)	6.9 CFS	Bypass flow rating using Orifice flow equation**** with 5 inches water depth over grate				
Standard 2" Bypass (62PENNMHD)	8.1 CFS					
Solids Storage Capacity:		7.1 cubic ft				
Maximum Bag Flow Rate CFS	6.1	6.1	4.1	4.1	6.1	6.1
Total Oil Absorption Oz (if applicable):	NA	89	168	256	256	256
*Filtration Efficiency:		82%	82%	99%	99%	82%
***TS (Total Suspended Solids) Removal		82%	82%	99%	99%	82%
****TPH (Total Petroleum Hydrocarbon) Removal		97%	97%	97%	97%	97%

ALL PRODUCTS MANUFACTURED BY INLET & PIPE PROTECTION, INC A DIVISION OF ADS, INC. WWW.INLETFILTERS.COM (866) 287-8655 PH (630) 355-3477 FX INFO@INLETFILTERS.COM

SIZE: 106180
SCALE: 1"=1'-0"
REV: A
SHEET 1 OF 1

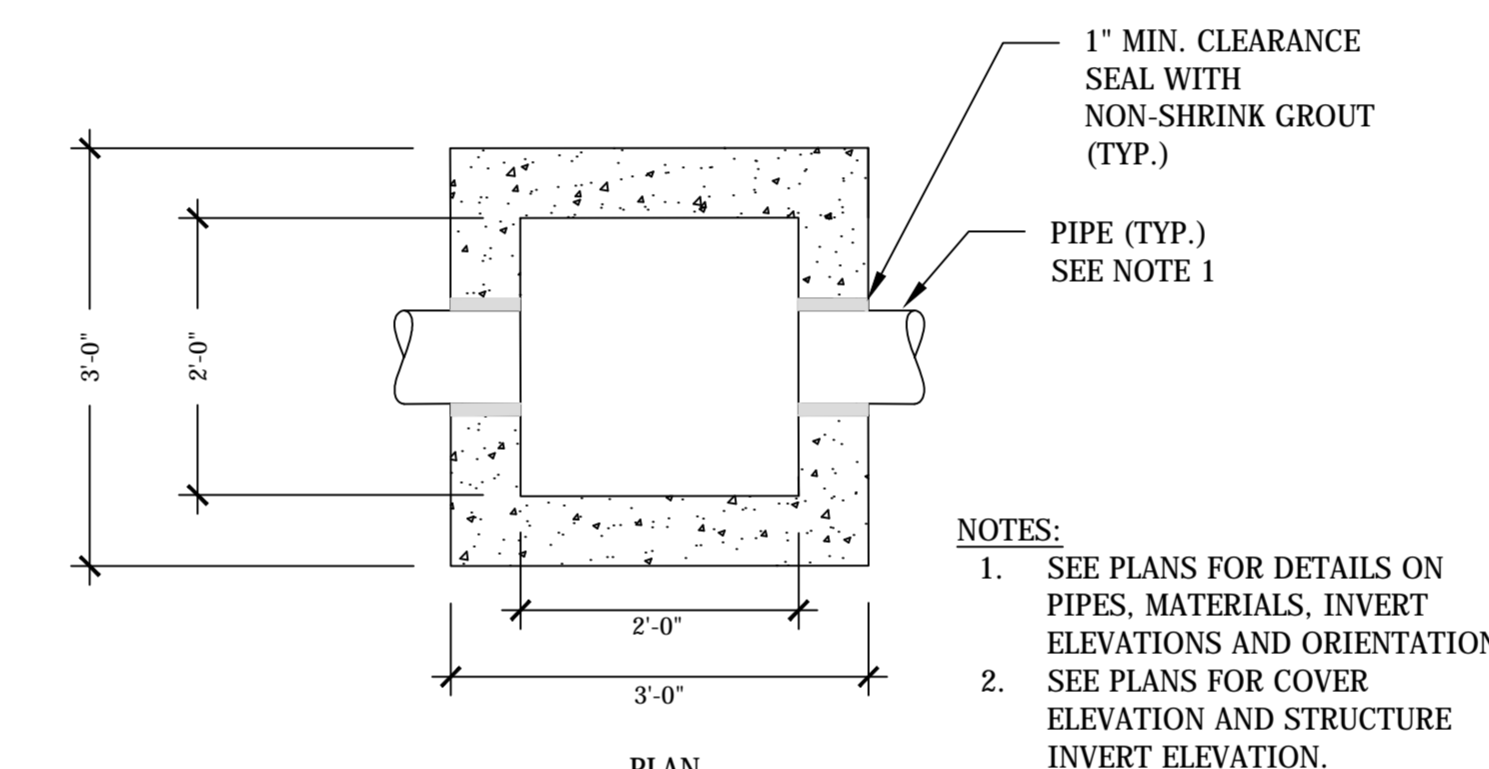

- NOTES:**
- SEE PLANS FOR DETAILS ON PIPES, MATERIALS, INVERT ELEVATIONS AND ORIENTATION.
 - SEE PLANS FOR COVER ELEVATION AND STRUCTURE INVERT ELEVATION.

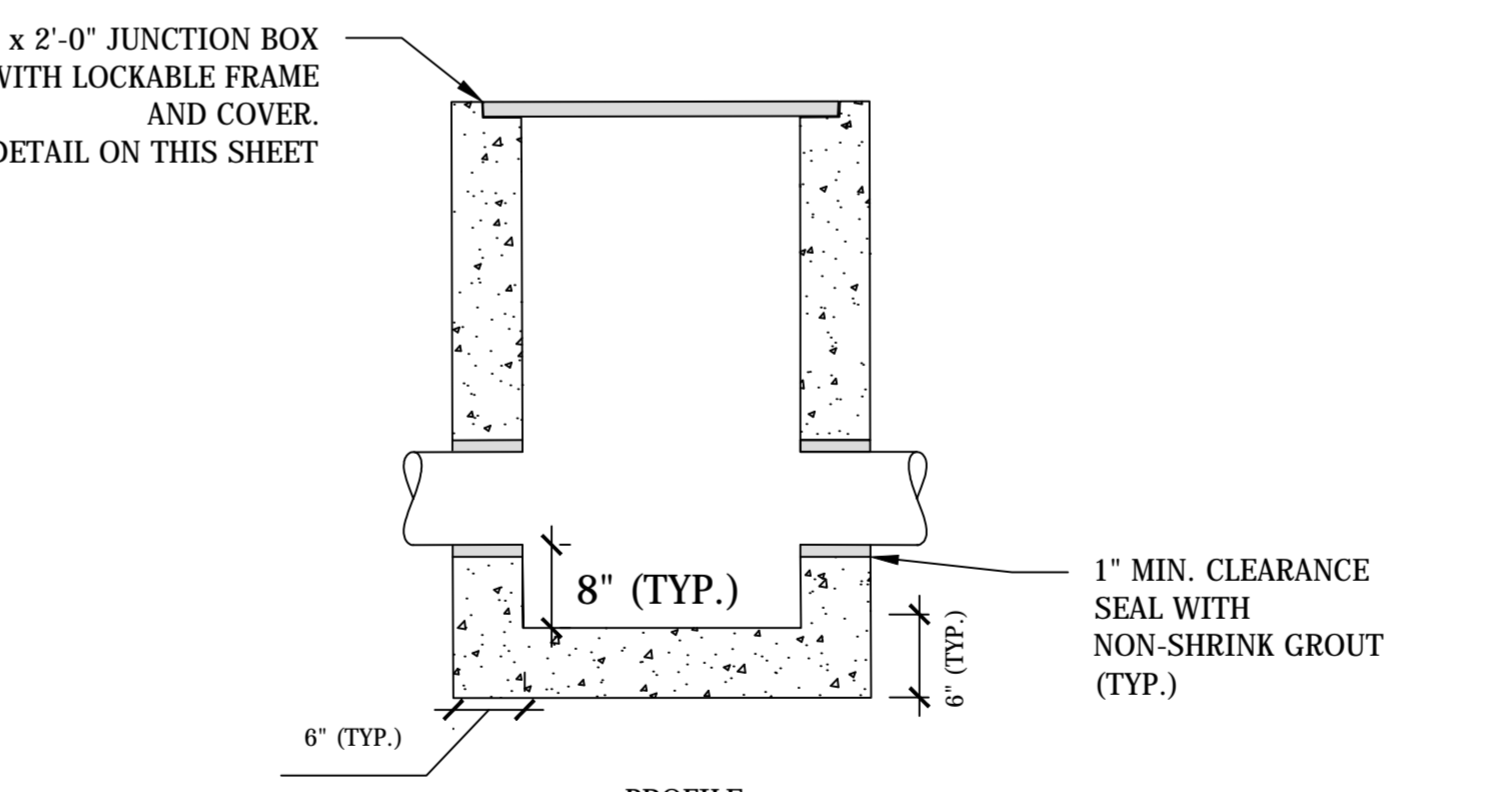

C-9: PWD JUNCTION BOX
NOT TO SCALE