

PWD and L+I PLUMBING INSPECTION JURISDICTION

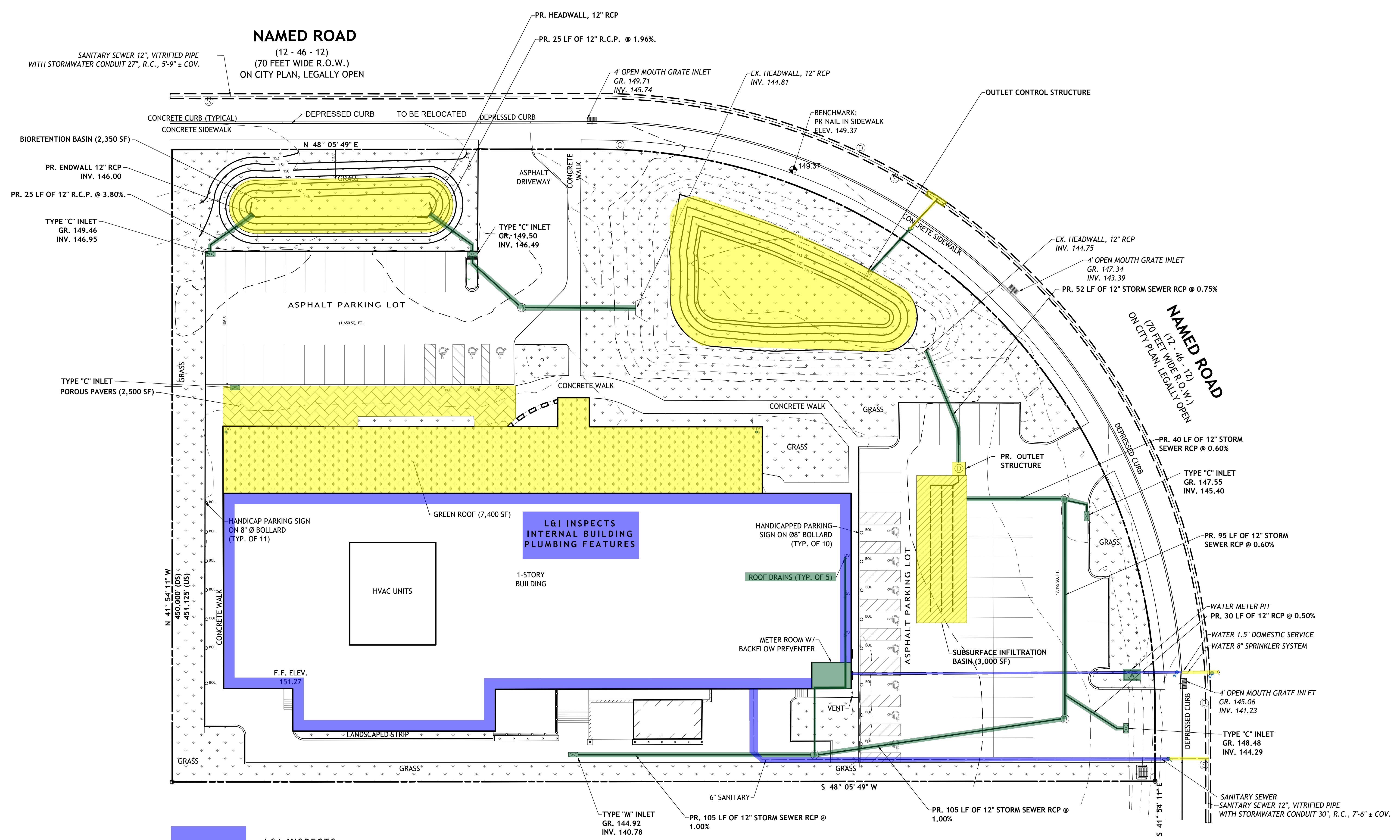

Legend for Inspection Jurisdiction:

- L&I INSPECTS
- PWD INSPECTS
- BOTH L&I AND PWD INSPECT

Inspection Contact Information				
Type	Department	Group	Contact Information	Lead Time
On-Site Stormwater Management and Conveyance	PWD	Active Construction Stormwater Inspections	215-685-6387	3 days
Drainage Lateral Connections < 8"	PWD	Water Transport Records	215-685-6271	48 hours
Drainage Lateral Connections > 8"	PWD	Plumbing Repairs Program	215-397-7097	48 hours
Water Connections < 2"	PWD	Drill Desk	215-685-9627	1-2 weeks
Water Connections > 3"	PWD	Water Conveyance	https://water.phila.gov/drops/schedule-your-new-water-connection-3-or-larger/	4-6 weeks
Private Cost	PWD	Construction	215-685-6345	7 days
Internal building and all on-site plumbing features	L&I	Construction Inspections Division	To schedule an inspection, refer to the L&I Permit for contact information.	24 hours

LEGEND

	EXISTING PROPERTY BOUNDARY		GAS VALVE
	METAL FENCE		WATER BOX
	CONTOUR LINE		VENT BOX SEWER
	PAVING STRIPPING LINE		UNKNOWN CURB BOX
	VEGETATION LINE / HEDGE		BENCHMARK
	TOP OF CURB ELEVATION		TRAFFIC SIGN
	BOTTOM OF CURB ELEVATION		BOLLARD
	SPOT ELEVATION		HANDICAPPED SYMBOL
	INVERT		4" OPEN MOUTH GRATE INLET
	GRATE		HEADWALL
	DEP. CURB		FOUND IRON PIN AT PROPERTY CORNER
	HANDICAPPED RAMP		DECIDUOUS TREE
	FOUND IRON PIN AT PROPERTY CORNER		LAMP POST
	DECIDUOUS TREE		FIRE HYDRANT
	LAMP POST		COMMUNICATION MANHOLE
	FIRE HYDRANT		DRAINAGE MANHOLE
	COMMUNICATION MANHOLE		SEWER MANHOLE
	DRAINAGE MANHOLE		WATER MANHOLE
	SEWER MANHOLE		WATER VALVE

PROPOSED

-
-
-
-
-
-
-
-
-
-

NOTES:

- L&I inspection is in accordance with the Philadelphia Plumbing Code.
- PWD inspection is in accordance with the Philadelphia Water Department Regulations.
- All inspections must be passed before L&I may release the Certificate of Occupancy.
- This plan was created to provide information about the jurisdiction for the Philadelphia Water Department (PWD) and License and Inspection (L+I) and contact information for the various units involved in inspecting plumbing features for private development. Questions about the plan can be directed to PWD_DevServices@phila.gov. Please contact the units listed in this document if you have specific questions about connections or scheduling inspections.

